

NATIVE AMERICAN FISH AND WILDLIFE SOCIETY



2024 ANNUAL

NATIONAL CONFERENCE

Sovereignty to Sustainability – Echoing our elders and nurturing our next seven generations

MAY 13 - 16, 2024

WELCH, MINNESOTA



TABLE OF CONTENTS

WELCOME ADDRESS	2
CODE OF CONDUCT	3
HOST HIGHLIGHT	4
KEYNOTE OVERVIEW	5
COMMITTEES	6-7
AGENDA	8-12
NATIONAL BUSINESS LUNCHEON AGENDA	13
WORKSHOP AGENDAS	14-15
SPONSOR SPOTLIGHT	17

WELCOME ADDRESS



**DONALD
REITER**
NAFWS President

Welcome everyone to this year's 2024 National NAFWS Conference and for some of you also attending this year's Great Lakes NAFWS Regional Conference.

Thank you to our Host Tribe the Prairie Island Indian Community for all of your intense work getting us ready for this week, you have been gracious host. Thank you to the Treasure Island Resort and Casino for providing a facility for allowing us this opportunity to get together and meet new friends as well as catching up with old friends.

But most of all, thank you all for attending this year's conference. The National NAFWS Planning Team have put together a wonderful agenda that highlights planned workshops, great presentations, and hopefully once we end this week, you can all go home and think of yourself as being part of a large family! I look forward to meeting as many of you as I possibly can. Please enjoy your week. I am here to help as needed! Thank you.



**JULIE
THORSTENSON, PHD**
NAFWS Executive Director

Welcome to the 41st Annual NAFWS National Conference! We have an amazing event ready for you all to enjoy thanks to our Great Lakes Regional planning team and to the Prairie Island Indian Community. Thank you to the NAFWS Staff and Board for all the work they do to make this week successful. Thank you to our numerous sponsors for their support.

NAFWS was created to bring Tribal fish and wildlife professionals together to network and raise issues to a national level with a unified voice. So as we gather this week, please remember to value the diversity of views and opinions, communicate with respect, be mindful of your colleagues and your surroundings. Take advantage of this unique opportunity to learn from each other and support the amazing work you are all doing.

Please feel free to connect with any of the staff and Board members this week to ask questions and share ideas. I hope to visit with as many of you as possible this week. Enjoy your time on the lands of the Prairie Island Indian Community. The agenda is full, I hope you leave with full hearts, minds and stomachs. Wopila Tanka.

CODE OF CONDUCT

The Native American Fish and Wildlife Society strives to provide a safe, inclusive environment for our participants, members and guests. We honor the teachings of our ancestors and values of our Native American and Alaska Native members, and we expect professional, respectful behavior. We hope to provide an environment that allows for professional, respectful networking, education and exchange of ideas. In order to ensure this, we have established the following guidelines for professional behavior during our events:

All participants should be treated with respect and consideration, valuing the diversity of views and opinions that may be different than those you hold.

- Communicate with respect for others; critique ideas rather than individuals.
- Avoid personal attacks directed towards conference participants.
- Be mindful of your colleagues and your surroundings.
- Professionalism and respect should be exercised at all time.

UNACCEPTABLE BEHAVIORS:

The following are examples of behavior that will not be tolerated at NAFWS sponsored events, including trainings and conferences:

- Harassment, threats, intimidation or discrimination of any kind or in any form;
- Physical, verbal or sexual abuse;
- Verbal comments related to gender, gender identity, sexual orientation, disability, physical appearance, race, religion, national origin which may reasonably be interpreted as offensive, insulting, or obscene or engaging in any conduct of a stalking or threatening nature directed to any participant or attendee.
- Behavior deemed to be excessively loud and/or disruptive of a meeting or any other event taking place during the event.
- Unlawful conduct or activity of any kind.

Reporting of Inappropriate Behavior:

- If you are the subject of or witness conduct in violation of these guidelines at the NAFWS events please notify a NAFWS staff or Board of Directors member.
- NAFWS will use reasonable efforts to respond and attempt to resolve the matter in a timely manner respectful of the parties and necessary to ensure the continued integrity and quality of the conference.
- Anyone experiencing or witnessing behavior that constitutes an immediate or serious threat to public safety at our event or in a convention center or hotel where the event is taking place is advised to locate a house phone and ask for security or dial 911.

NAFWS at all times reserves the right, in its sole and reasonable discretion, to have individuals acting in an unprofessional manner or contrary to these guidelines removed from any event taking place, forfeiting any registration and/or fees. The right to prohibit attendance at any future event and/or revocation of NAFWS membership may also apply. Attendance at the NAFWS events is a privilege, not a right. We appreciate your attention to these guidelines and wish you a productive and meaningful experience.

HOST HIGHLIGHTS

PRAIRIE ISLAND INDIAN COMMUNITY

The Prairie Island Indian Community is a federally recognized Indian tribe. The Tribe received recognition following the formal adoption of its Constitution and By-Laws on June 20, 1936, under the Indian Reorganization Act. The Tribe's reservation was created in the late 1880s, when the U.S. Secretary of the Interior purchased and placed into federal trust approximately 120 acres of land for the landless Bdewakantunwan families residing in Minnesota.



SELF GOVERNANCE; SELF SUFFICIENCY

The ability to govern ourselves and provide services to our members is an inherent right and responsibility we take seriously. We are proud that not only can we meet the needs of our members, we also are creating a positive impact for our neighbors.

We are the largest employer in Goodhue County, with more than 1,500 employees. Our enterprises, which include the second largest hotel property in Minnesota, help to generate more than \$18 million in state and federal taxes. And we are an economic engine for the region, spending nearly \$60 million with Minnesota businesses and donating more than \$25 million to non-profit and community organizations over the past 20 years.

Revenue from our enterprises, funds our government and allows us to provide basic services to our members, including health care, education, and community infrastructure. It also provides the necessary resources to protect our future, by ensuring that our voices are heard as we fight back against the injustices that continue against our Tribe.

Our obligation as a sovereign government to protect the welfare of our members doesn't end with the current generation. We are focused on providing for and protecting the next seven generations.



KEYNOTE SPEAKERS



LINDA BLACK ELK
FOOD SOVEREIGNTY ACTIVIST

Linda and her husband Luke are food sovereignty activists and teachers of traditional plant uses, gardening, food preservation, and foraging. They spend their time collecting and preparing traditional foods and medicines for Indigenous peoples and communities in North Dakota, South Dakota, Minnesota, and beyond. Luke is one of the founding board members of the Tatanka Wakpala Model Sustainable Community, which is a Native non-profit on the Cheyenne River Nation focusing on traditional building design, permaculture, food sovereignty, and a return to Lakota spirituality as a guide for everyday life. Linda currently serves as the Educational Programming and Community Development Leader at NATIFS. Luke is the Farm Director at Hohwoju Otunwe, a 16-acre organic farm on recovered homelands of the Oceti Šakowin in southern Minnesota. Together, Luke and Linda sit on the board of Makoce Ikkicupi, a Native non-profit, which is a Reparative Justice project on Dakota lands. Luke and Linda make sure their three sons stay involved in all of this important work, so they may learn about the importance of feeding themselves and their communities with food and medicine that nourishes and heals mentally, emotionally, physically, and spiritually.



NICOLE BUCK
Bdewakantuwan Dakota

Nicky is Bdewakantuwan Dakota from Tinta Wita (Prairie Island) Mni Sota. Born and raised in her tribal nation of Prairie Island, she had the opportunity to work within the Land & Environment Dept. She serves many roles within her community such as serving as a core committee member for the Wicozani Wašte (Good Health) Committee, organizing and coordinating cultural teachings and food sovereignty events for the Prairie Island Dakota Community and beyond.

COMMITTEES

CONSERVATION LAW ENFORCEMENT OFFICER



Purpose: established to advance Conservation Law Enforcement Program Enhancement for Tribes.

ALL CLEOS ARE WELCOME TO ATTEND!!

DUTIES:

- Identify, develop, and plan training and programming for NAFWS CLEO membership,
- Work and advocate to secure funding for Tribal CLEO programs,
- Gather input from CLEOs to establish national and regional goals and objectives,
- Review, revise, and promote the NAFWS Hunter Education Program. This committee would also serve as a forum for CLEO to present concerns and suggestions to expand Tribal Conservation Law Enforcement throughout NAFWS Regions.

CLEO COMMITTEE RESPONSIBILITIES

- Communicate with regional contacts to help facilitate CLEO needs
- Remote engagement of CLEOs at Regionals and National

AGENDA:

5:00 p.m. Call to Order

- Housekeeping, and Summary of January 2024 Meeting Minutes
- Review of Historical CLEO Documents
- Review of 2024 CLEO Training Schedule
 - 40-hour CLEO ALERRT Training: Quapaw – June 3-7
 - Motorboat Operator’s Training: Blackfeet – July 15-19
 - 40-hour CLEO ALERRT Training: Billings, MT – July 29-Aug 2
 - Mental Health Webinar – August 7
 - CLEO Committee Meeting – August 21
 - Tactical Communications for Rookie Officers Webinar – October 10
 - CLEO Committee Meeting – November 19
- Timing on Tribal Cases Prosecution by Feds
- 2025 Training Needs and Schedule
- Open Discussions, as needed

6:00 p.m. Adjourn Meeting

RESEARCH & PUBLICATIONS



Purpose: Aid Tribal fish and wildlife professionals navigate, pursue and apply the different aspects of contemporary research related issues including research guidance, data sovereignty, professional growth, funding, publications and academia involvement.

MUST BE A NAFWS MEMBER TO PARTICIPATE IN THIS COMMITTEE

AGENDA:

9:00 a.m. Welcome and Introductions

Hannah Golden, NAFWS

10:05 a.m. Federal Partners Update

10:10 a.m. Data Sharing Agreement Presentation

Dr. Caleb Hickman, EBCI

10:25 a.m. Brainstorming Session

10:50 a.m. Final Announcements & 2024 Goals

COMMITTEES

FEDERAL & STATE RELATIONS

PURPOSE: Establish a Board of Directors committee to facilitate partnerships and communication with Federal and State partners.



EVERYONE WELCOME TO ATTEND

DUTIES:

- Provide opportunity for discussion, deliberation, and action with respect to fish and wildlife conservation in the context of the three sovereign entities which have various jurisdictional authority over these resources: Tribal governments, the Federal Government and state fish and wildlife agencies.
- Coordinate effective delivery of stewardship and conservation of fish and wildlife resources.
- Seek the highest standards for conservation activities to ensure that actions and resources are effective and efficient.
- Assure the appropriate jurisdictional relationship between the three sovereign entities in legislative, executive and treaty initiatives.

MEETINGS:

The FSR Committee will meet at least quarterly with one meeting in person at the Annual NAFWS National Conference.

AGENDA:

1. **Call to Order** – Julie Thorstenson, PhD
2. **Welcome and Introductions**
3. **Seating of two NAFWS members at large to committee**
4. **Federal Updates** (3-5 minutes each)
 - a. BIA
 - b. FWS
 - c. USGS
 - d. BLM
 - e. USFS
 - f. Other
5. **State Updates** (3-5 minutes each)
 - a. AFWA
 - b. Individual States present
6. **General Discussion**
 - a. Co-management
7. **Other**
8. **Adjournment**



AGENDA

MONDAY, MAY 13, 2024

8:00 a.m. – 1:00 p.m. Location: Red Wing Sportsman's Club, 966 Hall Strom Drive, Red Wing, MN 55066	National CLEO Competition Shoot <i>Coordinators:</i> Kevin Willis, Chief Conservation Officer – Little Transverse Bay Band of Odawa Indians Kevin Modlin, Conservation Officer – Pokagon Band of Potawatomi *Carpooling Available
8:00 a.m. – 5:00 p.m. Location: Foyer	Exhibitors/Vendors Set-Up <i>Coordinator:</i> Andy Edwards, ATBC Field Liaison – NAFWS
9:00 a.m. – 5:00 p.m. Location: Foyer	Registration <i>Coordinators:</i> Heidi McCann, Office Manager & Membership Coordinator—NAFWS Jennifer Bills, Financial Advisor – Management Partners
9:00 a.m. – 11:00 a.m. Location: Tahiti Room	Meeting: NAFWS Research/Publication Committee <i>Coordinator:</i> Hannah Golden, Fish & Wildlife Biologist – NAFWS -SEE ATTACHED AGENDA-
10:00 a.m. – 5:00 p.m. Location: Wolf/Eagle	Workshop: Wildlife Health/Personal Protective Equipment <i>Coordinators:</i> Tolani Francisco, DVM, Wildlife Disease Coordinator – NAFWS Shailyn Wiechman, Wildlife Connectivity Coordinator – NAFWS —SEE WORKSHOP AGENDA—
10:00 a.m. – 12:00 p.m. Location: Bear/Buffalo	Meeting: Federal & State Relations Committee <i>Coordinator:</i> Julie Thorstenson Ph.D., Executive Director – NAFWS -SEE ATTACHED AGENDA-
1:00 p.m. – 5:00 p.m. Location: Bear/Buffalo	Workshop: NASA Earth Observations for Habitat Monitoring <i>Coordinators:</i> Laurel James Ph.D.(c), Director of Programs – NAFWS Emily Hagler, Fish & Wildlife Biologist – NAFWS —SEE WORKSHOP AGENDA—
1:00 p.m. – 5:00 p.m. Location: Capri	Workshop: Invasive Species Management Planning <i>Coordinator:</i> Mitzi Reed, Invasive Species Coordinator – NAFWS —SEE WORKSHOP AGENDA—
1:00 p.m. – 5:00 p.m. Location: Tahiti	Workshop: Project Management for ATBC <i>Presenter:</i> John Hendrix, Facilitator, First Nations Development Institute <i>Coordinator:</i> Megan Hawkins, Grants Coordinator – NAFWS —SEE WORKSHOP AGENDA—
5:30 p.m. – 7:00 p.m. Location: Bear/Buffalo	Meeting: NAFWS Great Lakes Region Business Meeting <i>Coordinators:</i> Donald Reiter and Terry Metoxen, GL Regional Directors – NAFWS *Hot Hors D'Oeuvres Will Be Served —SEE MEETING AGENDA—
7:00 p.m. – 10:00 p.m. Location: Island Xtreme Bowling	Professional Mixer (networking opportunity) *Hot Hors D'Oeuvres Will Be Served



AGENDA

TUESDAY, MAY 14, 2024

8:00 a.m. – 5:00 p.m. Location: Foyer	Registration <i>Coordinators:</i> Heidi McCann, Office Manager & Membership Coordinator—NAFWS Jennifer Bills, Financial Advisor – Management Partners
8:00 a.m. – 5:00 p.m. Location: Foyer	Exhibitors/Vendors Set-Up <i>Coordinator:</i> Andy Edwards, ATBC Field Liaison – NAFWS
9:00 a.m. – 9:45 a.m. Location: Island Event Center	Opening Ceremony Master of Ceremonies – Donald Reiter, President & Great Lakes Regional Director - NAFWS Posting of the Colors – Conservation Law Enforcement Officers Invocation – Johnny Johnson, Prairie Island Indian Community Elder <i>Welcoming Remarks:</i> Prairie Island Indian Community Representative – Johnny Johnson, Elder Minnesota Lieutenant Governor - Peggy Flanagan, Invited NAFWS Executive Director – Julie Thorstenson, Ph.D. NAFWS President, Great Lakes Region Director – Donald Reiter NAFWS Great Lakes Region Director – Terry Metoxen
9:45 a.m. – 10:00 a.m. Location: Island Event Center	Conference Overview <i>Presenter:</i> Gabriel Miller, Environmental Program Manager - Prairie Island Indian Community
10:00 a.m. – 10:45 a.m. Location: Island Event Center	Keynote Address: <i>Presenter:</i> Linda Black Elk, Ethnobotanist <i>Moderator:</i> Donald Reiter, Great Lakes Regional Director & President – NAFWS
10:45 a.m. – 11:30 p.m. Location: Island Event Center	Presentation: Prairie Island Indian Community – Fisheries and Wildlife Management Overview <i>Presenter:</i> Gabriel Miller, Environmental Program Manager - Prairie Island Indian Community
11:30 p.m. – 12:00 p.m.	Presentation: Experience of Prairie Island Community Members Restoring/Harvesting Wild Rice on the Mississippi River
12:00 p.m. – 1:30 p.m.	LUNCH ON YOUR OWN
1:30 p.m. – 2:30 p.m. Location: Island Event Center	Presentation: NAFWS National Conference Update <i>Presenter:</i> Julie Thorstenson Ph.D., Executive Director – NAFWS
2:30 p.m. – 3:00 p.m. Location: Island Event Center	Presentation: Framing Tribal Conservation Science: Research on Recovering America’s Wildlife Act (RAWA) and medical relations for Indigenous Scientists <i>Presenter:</i> Ryan Comfort, Ph.D. – Assistant Professor, Indiana University – The Media School
3:00 p.m. – 3:15 p.m.	BREAK – Sponsored by Center of Large Landscape Conservation
3:15 p.m. – 4:00 p.m. Location: Island Event Center	Presentation: Funding Opportunities for Tribal Fish and Wildlife <i>Presenters:</i> Arielle Mion, Program Manager, Coastal Resilience – National Fish and Wildlife Foundation Rachel Dawson, Program Director, National Programs – National Fish and Wildlife Foundation, Kelly Dennis, Partnership Strategist, Office of Strategic Partnerships, Department of the Interior <i>Moderator:</i> Megan Hawkins, Grants Coordinator – NAFWS
4:00 p.m. – 5:00 p.m. Location: Island Event Center	Presentation: Federal Partner Updates <i>Presenters:</i> BIA – Johnna Blackhair, Deputy Bureau Director of Trust Services USFWS – Gary Frazer, Deputy Director - Operations USGS – Jennifer Lacey, Regional Director of Region 3: Great Lakes Missouri Basin BLM – Brian St George, BLM Deputy Assistant Director for Resources and Planning <i>Moderator:</i> Terry Metoxen, GL Region Director – NAFWS
5:00 pm – 6:00 pm Location: Bear/Buffalo	Meeting: CLEO Committee – ALL NAFWS CLEO’s Invited <i>Coordinator:</i> Mitzi Reed, Invasive Species Coordinator – NAFWS
6:30 p.m. – 8:00 p.m. Location: Island Event Center	Traditional Feast Host: Prairie Island Indian Community

AGENDA

WEDNESDAY, MAY 15, 2024

8:00 a.m. – 5:00 p.m.
Location: Foyer

Registration

Coordinators: Heidi McCann, Office Manager & Membership Coordinator – NAFWS

8:00 a.m. – 5:00 p.m.
Location: Foyer

Exhibitors/Vendors

Coordinators: Andy Edwards, ATBC Field Liaison – NAFWS
Concurrent Sessions I

Topic	Fisheries Management	Climate	Wildlife Management	Federal Partnerships	CLEO Training
Moderator:	Donald Reiter, GL Regional Director	T. Jason Mitchell, NE Regional Director	Shailyn Wiechman, Wildlife Connectivity Coordinator	Matt Gamble, SE Regional Director	Terry Metoxen, GL Regional Director
Location:	Bear/Buffalo	Capri	Wolf/Eagle	Tahiti	Event Center
9:00 a.m. – 9:30 a.m.	Habitat Assessments and Modeling to Support Artic Grayling Reintroduction Zachary Locklear, Graduate Research Assistant University of Wisconsin-Green Bay	Indigenous partnerships to support name (lake sturgeon) fisheries climate adaptation Holly Embke, Research Fish Biologist USGS Midwest Climate Adaptation Science Center	Monitoring Moose and other culturally important wildlife on Penobscot Indian Nation Lands using remote cameras Benjamin Simpson, Wildlife Resource Manager Penobscot Department of Natural Resources	Collecting and Integrating Indigenous Knowledges into the Yellowstone Bison Species Status Assessment Jim Boyd, Fish and Wildlife Biologist U.S. Fish and Wildlife Service	Training: Human Trafficking Awareness & Identification Stephanie Greaf, s7 Consulting
9:30 a.m. – 10:00 a.m.	Elevating Tribal Voices to Restoring Watershed Functions and Conserve the Clear Lake Hitch Daniella Santana Cazares, Environmental Director Habematolel Pomo of Upper Lake	Ganawenindiwag: Working with plant relatives to heal and protect Gichigami shorelines Rob Croll, Policy Analyst/Climate Change Program Coordinator Great Lakes Indian Fish & Wildlife Commission	Collaborative aerial surveys for monitoring Mooz in the 1854 Ceded Territory Morgan Swingen, Wildlife Biologist 1854 Treaty Authority	Metabarcoding Aquatic Invasive Species: Early Detection and Monitoring in the Great Lakes Basin Rachel Brown, Deputy Project Leader, Whitney Genetics Laboratory U.S. Fish and Wildlife Service	Human Trafficking Awareness & Identification Cont'd
10:00 a.m. – 10:30 a.m.	Restoration of Buffalo Slough Island in the Mississippi River for Native Mussel Protection Gabriel Miller, Environmental Program Manager Prairie Island Indian – Land and Environment Department	BIA's Tribal Climate Resilience Program Zachary Jorgenson, Regional Climate Resilience Coordinator Bureau of Indian Affairs	Population dynamics of black bears (Ursus americanus) on the Red Cliff Reservation and Apostle Islands Monica Cooper, PhD Student University of Wisconsin, Madison	The Collaborative Great Lakes Manoomin (Wild Rice) Project Lara O'Brien, Geospatial Analyst NOAA	Human Trafficking Awareness & Identification Cont'd

BREAK 10:30 a.m. – 11:00 a.m.

Concurrent Sessions I (cont.)

Topic	Fisheries Management	Biodiversity	Wildlife Management	Threatened and Endangered Species	CLEO Training
Moderator:	Hope Roberts, AK Regional Director	Michael Thompson, GP Regional Director	Benjamin Simpson, NE Regional Director	Shaun Grassel, PhD, GP Regional Director	Terry Metoxen, GL Regional Director
Location:	Bear/Buffalo	Capri	Wolf/Eagle	Tahiti	Event Center
11:00 a.m. – 11:30 a.m.	Blackfoot Nation Westslope Cutthroat Trout Status Assessment Project Jeremiah North Piegan, Fish Biologist & Fisheries Program Manager Blackfoot Fish and Wildlife Department	A Survey of Wildlife on Ho-Chunk Nation Lands Using Trail Cameras James Swenson, Wildlife Biologist Ho-Chunk DNR	Tribal Big Horn Sheep Management on the Flathead Indian Reservation Shannon Clairmont, Supervisory Biologist CSKT Wildlife Management/Bison Range	Homes on the Range – Potential landscapes for conservation across the Central grasslands of North America: Integrating keystone species, land use, and climate change Lindsey Sterling Krank, Program Director, Prairie Dog Conflict Resolution Humane Society of the United States- Wildlife	Human Trafficking Awareness & Identification Cont'd
11:30 a.m. – 12:00 p.m.	A chemical prioritization process for chemicals of emerging concern in subsistence fish and freshwater ecosystems with recommendations on improving policy to address emerging contaminants in subsistence foods Seth Moore, Ph.D., Director of Biology and Environment Grand Portage Band of Lake Superior Chippewa	Exploring Riparian Species Diversity in Northern Colorado with Traditional Ecological Knowledge Lizzy Osterhoudt, Student Colorado State University	The Mysterious Death of Wolf M2022-33 (Kristoff) Dave Price, Wildlife Biologist Red Lake DNR - Wildlife	Chahta Halambisha: Supplementing Bat Habitat in the Choctaw Nation of Oklahoma Using Bat Houses Jordan Grotts, Wildlife Biologist Choctaw Nation of Oklahoma	Human Trafficking Awareness & Identification Cont'd

12:00 p.m. – 2:00 p.m.
Location: Island Event Center

NAFWS NATIONAL BUSINESS MEETING

Coordinator: Donald Reiter, NAFWS President and Julie Thorstenson, PhD, NAFWS Executive Director
LUNCH PROVIDED

AGENDA

WEDNESDAY, MAY 15, 2024

Concurrent Sessions II

Topic	Invasive Species	Traditional Ecological Knowledge	Wildlife Management	Education/Outreach	CLEO Training
<i>Moderator:</i>	<i>Mitzi Reed, Invasive Species Coordinator</i>	<i>Katie Schultz, AtBC Field Liaison</i>	<i>Laurel James, Ph.D.(c), Director of Programs</i>	<i>Kai'T Bluesky, SW Regional Director</i>	<i>Terry Metoxen, GL Regional Director</i>
<i>Location:</i>	Bear/Buffalo	Capri	Wolf/Eagle	Tahiti	Event Center
2:00 p.m. – 2:30 p.m.	Invasive Signal Crayfish of Kodiak Island, Alaska <i>Daniel Smith, Tribal Biologist</i> Sun'aq Tribe of Kodiak	Anwebimagada "Letting it rest" Anishinaabe Perspectives of Natural Resource Management <i>Michael Waasegiizhig- Price, Traditional Ecological Knowledge Specialist</i> Great Lakes Indian Fish and Wildlife Commission	Mycoplasma ovipneumoniae (M. ovi in the Bandlands) <i>Michael Thompson, Wildlife Biologist</i> Oglala Sioux Parks and Recreation Authority	2023 SYP Student Wildlife Management Plan <i>Contest Winners: Eshpaa Salvedra, Xan Francis, Maya Craven & Cody Tsinnijinnie</i>	Active Shooter Simulation Training <i>Coordinator: Lt. Scott Hanley,</i> Pokagon Band of Tribal Police Department
2:30 p.m. – 3:00 p.m.	Robinson Rancheria Invasive Species Management and the capacity to be successful <i>Luis Santana, Water Manager</i> Robinson Rancheria Pomo Indians of California	Promoting the rights of the Chugach Region Tribes while helping meet their subsistence, cultural, and economic needs through sustainable resource management <i>Dustin Carl, Tribal Wildlife Biologist</i> Chugach Regional Resources Commission	Monitoring Bat Populations on Penobscot Nation Tribal Lands Through Acoustic Surveys <i>Benjamin Simpson, Wildlife Resource Manager</i> Penobscot Nation Department of Natural Resources	Education and Outreach on White Earth Reservation "Bridging a gap for youth, elders, vulnerable populations" <i>Jason Clark, Environmental Coordinator 2</i> <i>Zoe Keezer, Environmental Coordinator</i> <i>Ashely Zurn, Conservation Officer</i> White Earth Natural Resources Division	Active Shooter Simulation Training Cont'd

BREAK 3:00 p.m. – 3:30 p.m.

Concurrent Sessions II (cont.)

Topic	Invasive Species	Traditional Ecological Knowledge	Wildlife Health - Chronic Wasting Disease	Federal Funding & Tribes	CLEO Training
<i>Moderator:</i>	<i>Darren Talayumptewa, SW Regional Director</i>	<i>Ted Lamebull, Jr., PA Regional Director</i>	<i>Donna Nez, PA Regional Director</i>	<i>Megan Hawkins, Grants Coordinator</i>	<i>Terry Metoxen, GL Regional Director</i>
<i>Location:</i>	Bear/Buffalo	Capri	Wolf/Eagle	Tahiti	Event Center
3:30 p.m. – 4:00 p.m.	Installation of Pre-Planted Pallets via Helicopter to Restore Inaccessible Reed Canarygrass-dominated Wetlands <i>Todd Gray, Environmental Protection Ecologist</i> The Tulalip Tribes	Elevating Indigenous Knowledge at the U.S. Fish and Wildlife Service: Successes and Cautions <i>Paige Schmidt, Indigenous Knowledge and Co-Stewardship Coordinator</i> U.S. Fish & Wildlife Service	MNPRO: A Multidisciplinary Think-Tank to Meet the Challenges of Chronic Wasting Disease <i>Tiffany Wolf, Assistant Professor</i> University of Minnesota	America the Beautiful Challenge (ATBC) Grants Panel Discussion <i>Andy Edwards and Katie Schultz, ATBC Field Liaisons - NAFWS</i>	Active Shooter Simulation Training Cont'd+F32:F33
4:00 p.m. – 4:30 p.m.	White Earth Tribal Pesticide Program and Projects <i>Renee Keezer, Pesticide Coordinator</i> White Earth Natural Resources Pesticide Program	Pa'Ashi-The Return of Tulare Lake <i>Hank Brenard, EPA Director</i> Santa Rosa Rancheria Tachi Yokut Tribe	Community-Based Participatory Approaches to Develop Chronic Wasting Disease Outreach and Management with Tribal Communities <i>Roger Faust, Ph.D.(c)</i> University of Minnesota	America the Beautiful Challenge (ATBC) Grants Panel Discussion Cont'd	Active Shooter Simulation Training Cont'd
4:30 p.m. – 5:00 p.m.	Estimating Horse and Burro Population Sizes on Tribal Lands <i>Jacob Hennig, Assistant Extension Specialist</i> University of Arizona	The Importance of Recovering the Cultural, Environmental, and Ecologically Significant Rivercane <i>Marvin Bouknight, Wildlife Biologist</i> Catawba Indian Nation	Evaluating the Midwest Tribal CWD Surveillance Network <i>Colin Yoder, Assistant Professor</i> University of Minnesota	Tribal Engagement in Sagebrush Steppe Bipartisan Infrastructure Law Funding Implementation <i>Stephanie Hebert, Wildlife Biologist</i> U.S. Fish & Wildlife Service	Active Shooter Simulation Training Cont'd

ADJOURN 5:00 p.m.

Tribal Student and Professional Mixer and Poster Session

Coordinator: Ashley Mueller, Education Coordinator – NAFWS

Instructions for Poster Presenters: Set-up Posters between 3:00 p.m. – 4:45 p.m. on Wed. May 14th

**Hors D'Oeuvres will be served*

5:00 p.m. – 7:00 p.m.
Location: Paradise Cove

AGENDA

THURSDAY, MAY 16, 2024

<p>6:45 a.m. – 8:30 a.m. Location: Starting Line – North Casino Parking Lot, on buffalo slough trail</p>	<p>5K Keya Stampede <i>Coordinators:</i> Thomas Hafen, Invasive Species Technician - NAFWS & Katie Schultz, AtBC Field Liaison – NAFWS <i>Instructions:</i> Pre-registrants receive race packet at the registration desk. On-site registration at conference registration desk. Meet at Starting Line at 6:45 a.m. Safety Briefing at 6:50 a.m. Race Starts at 7:00 a.m.</p>
<p>9:30 a.m. – 5:00 p.m. Transportation Provided</p>	<p>Natural Resources Tours: <i>Coordinators:</i> Gabriel Miller, Environmental Program Manager - Prairie Island Indian Community <i>Instructions:</i> Meet at Hotel Lobby Entrance at 9:15 a.m. Shuttles Depart at 9:00 a.m.</p>
<p>9:00 a.m. – 5:00 p.m. Location: Event Center</p>	<p>CLEO Training: “Active Shooter” Simulation Training <i>Coordinator:</i> Lt. Scott Hanley, Pokagon Band of Tribal Police Department</p>
<p>6:30 p.m. – 9:30 p.m. Location: Island Event Center</p>	<p>BANQUET <i>Master of Ceremony:</i> Donald Reiter, President/GL Regional Director - NAFWS <i>Retire the Colors</i> <i>Invocation:</i> <i>Award Announcements:</i> Darren Talayumptewa, SW Regional Director - NAFWS National Tribal Student Poster Session Awards – Ashley Mueller, NAFWS Education Coordinator - NAFWS Regional Awards – Terry Metoxen, GL Regional Director - NAFWS Emerging Professional of the Year Award Biologist of the Year Award Chief Sealth Award National Conservation Officer Shoot Team Awards <i>Live and silent auction</i> – Benjamin Simpson, NE Regional Director & Ted Lamebull, PA Regional Director - NAFWS</p>



NATIONAL BUSINESS LUNCHEON

Time: 12:00 p.m. - 2:00 p.m.
Location: Island Event Center

AGENDA:

- Call to Order – Donald Reiter, President
- Introductions of Board Members – Donald Reiter
- Regional Updates – Board Members
- Financial Status Report – Darren Talayumptewa, Secretary/Treasurer
 - Jennie Bills, Accountant
- NAFWS Committee Updates:
 - Research & Publications – Hannah Golden, Fish & Wildlife Biologist – Biodiversity
 - Federal & State Relations – Mike LaVoie, Vice President
 - Conservation Law Enforcement Officers – Henry Bearheart
- NAFWS Legislation Updates – Julie Thorstenson, PhD, Executive Director
- Resolutions
- Membership – Reports, Resolutions, Discussion of Issues
- 2025 National Conference – Great Plains Region
- Adjourn



WORKSHOP AGENDAS

MONDAY, MAY 13, 2024

WILDLIFE DISEASE/PPE TRAINING

Time: 10:00 a.m. – 5:00 p.m.

Location: Wolf/Eagle Room

- **10:00 a.m., Welcome and Introductions**
- **10:00 a.m. - 11:00 a.m., Wildlife Diseases**
 - Rabies, SARs-CoV-2, Avian Influenza, Vector-Borne Diseases
 - Swine Flu, White-nose Syndrome, Bovine Tuberculosis, Epizootic hemorrhagic disease (EHD)
- **11:00 a.m. - 12:00 p.m., Chronic Wasting Disease (CWD)**
 - CWD Overview – Katie Easter and Daelyn Zagurski, USGS, Tribal CWD Management Plan, Tanay
 - Roerick, Leech Lake Band of Ojibwe, Sarah Ruffing, Red Lake Indian Reservation, Doug McArthur, White Earth Reservation, Roger Frost, University of Minnesota
- **12:00 p.m. - 1:00 p.m., Lunch on your own**
- **1:00 p.m. - 2:00 p.m., Personal Protective Equipment (PPE)**
 - Demonstration & Application of: Gloves, Footwear, Protective Clothing, Face Shields and Masks
- **2:00 p.m. - 4:30 p.m., Disease Sampling on Deer Heads and Birds**
 - Chronic Wasting Disease, Rabies, SARs-CoV-2, Vector-Borne Diseases, Bovine Tuberculosis, Epizootic hemorrhagic disease (EHD) Avian Influenza
- **4:30 p.m. - 4:50 p.m., PPE removal and Cleanup**
- **4:50 p.m. - 5:00 p.m., Debrief & Conclusions**

NASA EARTH OBSERVATIONS FOR HABITAT MONITORING

Time: 1:00 p.m. – 5:00 p.m.

Location: Bear/Buffalo Room

NASA's Indigenous Peoples Initiative would like to welcome you to our Native American Fish & Wildlife Annual Conference Training. We have titled this session NASA Earth Observations for Habitat Monitoring. This four-hour workshop will introduce participants to the application of NASA remote sensing data and tools for monitoring climate and landscape changes, with an emphasis on habitat monitoring. The workshop will include hands-on demonstrations of locating, accessing, visualizing, and interpreting online and freely available NASA data and products.

- **Introductions**
- **Situating in Place:** Contextualizing local habitat
- **Exercise:** Habitat Monitoring-Bison in NASA Worldview
- **Lecture:** Introduction to Remote Sensing for Fish & Wildlife Professionals
- **Research Interests from the Crowd**
- **DEMO -Land Processes Distributed Active Archive Center (LP DAAC) Application**
- **For Extracting and Exploring Analysis Ready Samples (AppEEARS)**
- **Work time**
- **Next Steps/Close**

WORKSHOP AGENDAS

MONDAY, MAY 13, 2024

INVASIVE SPECIES MANAGEMENT PLANNING WORKSHOP

Time: 1:00 p.m. – 5:00 p.m.

Location: Capri Room

Invasive species, also referred to as displaced relatives, are plants and animals that are found living in areas other than their native region. Since these species have not existed in the local balance of nature for hundreds of years, they often lack the disease/predators/competitors that limit their populations in their native range. Invasive species have the ability to change native landscapes which often leads to loss of edible, medicinal, and culturally important species as well as the reduction of wildlife habitat. It is important to protect native species and ecosystems; therefore, monitoring and management of invasive species is vital. Prevention is the most effective way to control the spread of displaced relatives and Early Detection Rapid Response (EDRR) practices should be considered when drafting management plans.

- **1:00 p.m., Call to Order, Introductions, Housekeeping**
 - Mitzi Reed, NAFWS Invasive Species Coordinator
- **1:05 p.m., Planning to Write or Revise an Invasive Species Management Plans**
 - Considerations when Writing an Invasive Species Management Plan - NAFWS Invasive Species Program Team
 - Considerations when Revising an Invasive Species Management Plan - Prairie Island Invasive Species Program
- **2:00 p.m., Early Detection and Rapid Response**
 - James English, USGS: "Incorporation of the National EDRR Framework"
 - Anna Ramthun: "Considering Context: Tailoring IPM and EDRR for Grand Ronde Goals"
 - Jennifer Hernandez USDA: "Environmental DNA sampling for aquatic invasive species"
 - Ed Rudberg: "PIIC/CD3 System" (with Trailer Exhibit and Demo)
- **3:20 p.m., BREAK (Walk out to CD3 Trailer and Break)**
- **3:40 p.m., Uses of Displaced Relatives**
 - Sammie Peterson: "PIIC Displaced Relatives"
 - Skye Pelliccia: "Uses of Noxious Weeds"
 - Caleb Hickman: "A Philosophical Change in Defining Invasive Species for Cherokee"
- **4:45 p.m., Discussion & Conclusions**
- **5:00 p.m., Adjourn**

PROJECT MANAGEMENT FOR ATBC

Time: 1:00 p.m. – 5:00 p.m.

Location: Tahiti Room

This will be an interactive workshop to learn the fundamentals of how to manage your projects effectively and efficiently. The facilitator will provide an overview of the fundamentals of project management and will walk through a step-by-step process to get a better handle on your projects. This workshop will include an actual case study example of an American the Beautiful Challenge grant project. You will leave the workshop with a proven process and a toolkit to make your ATBC, and other grant-funded projects, less stressful and more effective.

- **1:00 p.m., Welcome and Introductions**
- **1:30 p.m., 'This isn't Rocket Science!' Exercise**
- **2:00 p.m., The Fundamentals of Project Management**
- **2:30 p.m., The Project Management Process**
- **3:00 p.m., Break**
- **3:15 p.m., Continuing: The Project Management Process**
- **4:30 p.m., Q & A Session**
- **5:00 p.m., Adjourn**

VENUE INFORMATION

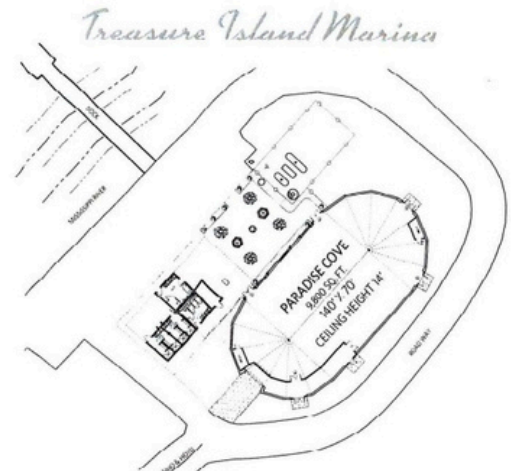
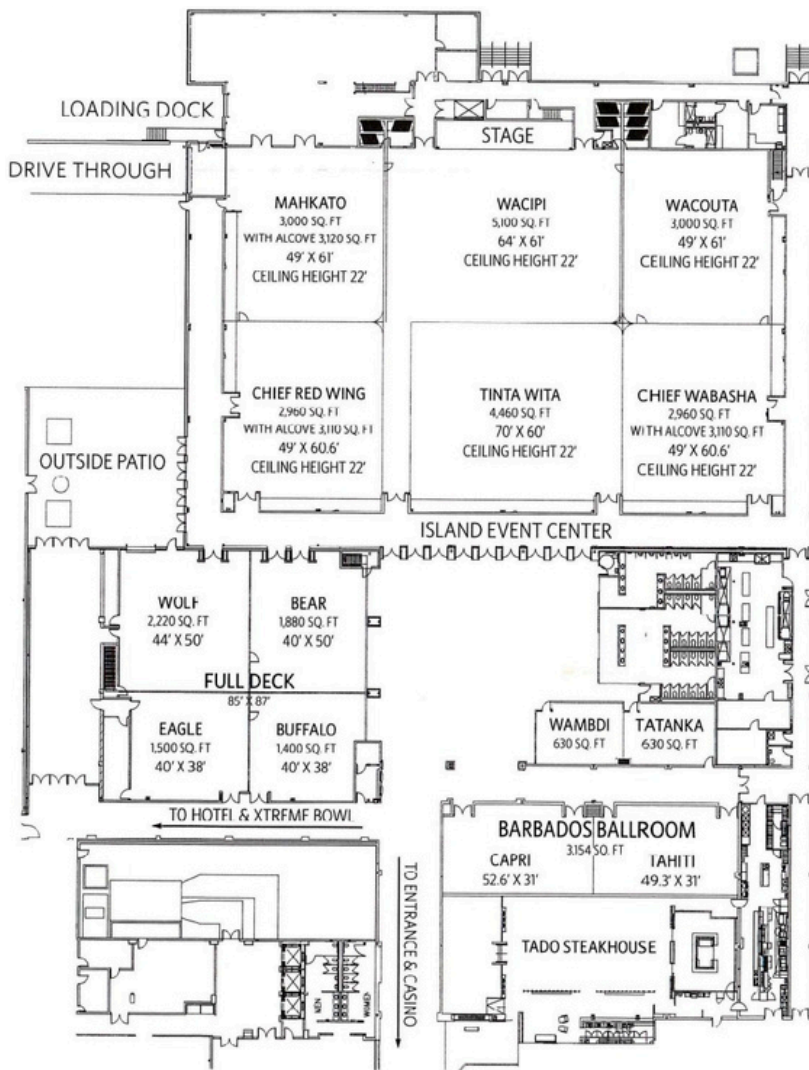

Island Event Center

KEYA STAMPEDE 5K FUN RUN

Race Day Details: Thursday, May 16th at 6:45 a.m. – 8:30 a.m.

Attendees will be back in time for Natural Resources Tours (Tours start at 9:00 a.m.)

- Pre-registrants receive race packet at the registration desk.
- On-site registration at conference registration desk (Cash, Card, Check Accepted).

Meet at Starting Line at 6:45 a.m. | Safety Briefing at 6:50 a.m. | Race Starts at 7:00 a.m.

CONTACTS:

Thomas Hafen

Invasive Species Technician
720-983-1010 ext. 214

Katie Schultz

ATBC Field Liaison
720-983-1010 ext. 211.



THANK YOU TO OUR PLATINUM SPONSORS!



THANK YOU TO OUR GOLD SPONSORS!



THANK YOU TO OUR SILVER SPONSORS!



THANK YOU TO OUR BRONZE SPONSOR!



Follow Us on Social Media



LET'S GET CONNECTED FOR OUR LATEST NEWS & UPDATES



on 'X' @NATIVE_WILDLIFE



on Facebook
@Native American Fish and Wildlife Society



on Instagram @NAFWS_INSTA



on TikTok @NAFWSTIKTOK



on LinkedIn
@Native American Fish and Wildlife Society

BE SURE TO VISIT OUR WEBSITE! WWW.NAFWS.ORG

THANK YOU!

FOR JOINING US

**WE LOOK FORWARD TO
SEEING YOU NEXT
YEAR IN THE GREAT
PLAINS REGION!**

